

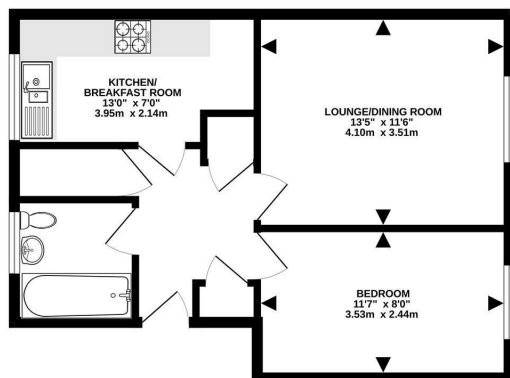

Second Floor
476 sq.ft. (44.2 sq.m.) approx.



epc:csnessex
TOTAL FLOOR AREA: 476 sq.ft. (44.2 sq.m.) approx.
While every effort has been made to ensure the accuracy of the provided information, measurements of rooms, fixtures, fittings and any other items are approximate and no responsibility is taken for any discrepancies. Prospective buyers should verify all measurements and details on site. The information is provided for guidance only and should not be relied upon for any legal or financial purposes. Please consult your solicitor for further details. Made with Magic3D



32 Britannia Road, Warley, Brentwood, CM14 5LG

We are pleased to present this beautifully maintained one-bedroom, second-floor apartment located in the sought-after area of Warley, Brentwood. Stylishly designed and well-presented throughout, the property boasts a contemporary fitted kitchen, a bright and spacious lounge, a generous double bedroom, a modern bathroom, and ample built-in storage.

Ideally situated just 0.8 miles from Brentwood Station, with excellent transport links into London and beyond, this home is perfectly suited for commuters. Brentwood High Street is also within easy reach, offering a wide selection of shops, restaurants, and bars.

With its superb location, modern finish, and broad appeal, this property is an ideal choice for first-time buyers, investors, or anyone seeking a convenient and stylish base with excellent transport connections.



Offers In Excess Of £225,000

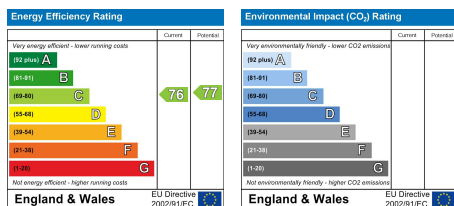

SERVICES:

Local Authority: Brentwood
Council tax band: B
Post code: CM14 5LG

VIEWING:

Strictly by prior arrangement with Keith Ashton Estate Agents

OPENING HOURS:

Monday to Friday: 8.45AM - 6.30PM | Saturdays: 9AM - 5.30PM | Sundays: 10AM - 2PM

MORTGAGE INFORMATION:

We offer the additional facility of an in-house Independent Financial Adviser who will access all mortgage lenders with the purpose of providing you with the benefit of choice. For quotations or comparables please call 01277 260858 or visit our interactive website at www.mortgagebusiness.net



We the Agent have not tested any apparatus, fittings or services for this property. The plot size is intended merely as a guide and has not been officially measured or verified by the Agent. Photographs are for illustration only and may depict items which are not for sale or included in the sale of the property. As part of the service we offer we may recommend ancillary services to you which we believe may help you with your property transaction. We wish to make you aware, that should you decide to use these services we will receive a referral fee. For full and detailed information please visit 'terms and conditions' on our website www.keithashton.co.uk

Brentwood
Tel. 01277 260858

Village Office
Tel. 01277 375757

Lettings Office
Tel. 01277 202200

Explore more @ www.keithashton.co.uk

